

- 40
- 41 E. The maximum height of a building or structure from the critical water quality
- 42 line along the eastern side of the Property to within 100 feet from the western
- 43 property line may not exceed 52 feet.
- 44
- 45 F. The maximum height of a building or structure on the remainder of the Property
- 46 may not exceed 35 feet.
- 47

48 Except as specifically restricted under this ordinance, the Property may be developed and

49 used in accordance with the regulations established for the multifamily residence

50 moderate-high density (MF-4) district and other applicable requirements of the City Code.

51

52 **PART 3.** This ordinance takes effect on _____, 2017.

53

54 **PASSED AND APPROVED**

55

56

57 §

58 §

59 _____, 2017 § _____

60 Steve Adler

61 Mayor

62





63

64 **APPROVED:** _____ **ATTEST:** _____

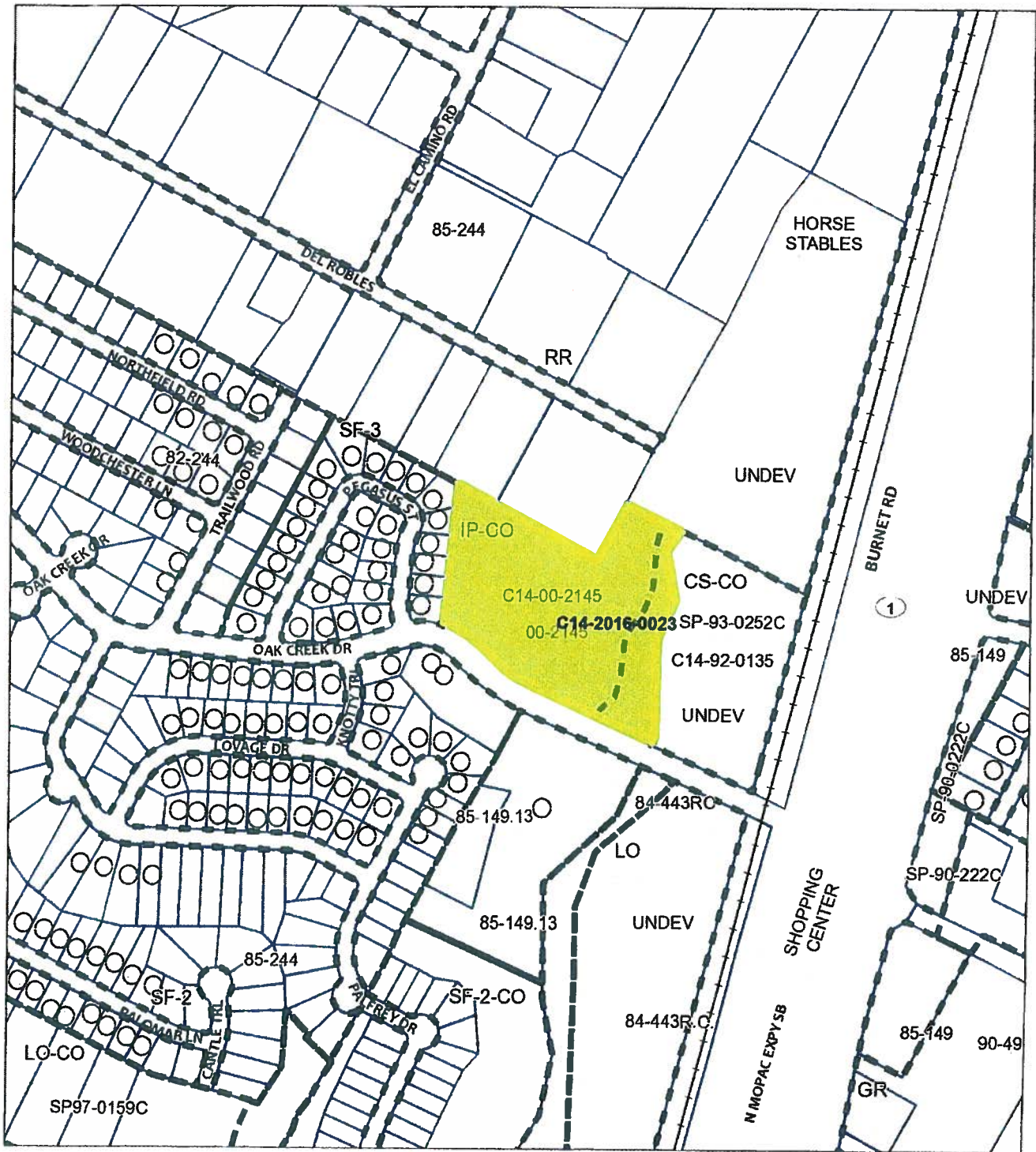
65 Anne L. Morgan Jannette S. Goodall

66 City Attorney City Clerk



-  Subject Tract
-  Pending Case
-  Zoning Boundary
-  Railroads

ZONING
ZONING CASE#: C14-2016-0023, SH

Exhibit A



1" = 400'

This product is for informational purposes and may not have been prepared for or be suitable for legal, engineering, or surveying purposes. It does not represent an on-the-ground survey and represents only the approximate relative location of property boundaries.

This product has been produced by CTM for the sole purpose of geographic reference. No warranty is made by the City of Austin regarding specific accuracy or completeness.